

ICBC and BC Transit team up to provide free shuttle service to the GVO, August 18-24

No matter how you slice it, transit to the Greater Vancouver Open is a winning idea. Bus/SeaBus/SkyTrain will drop you off daily at Surrey Central Station at regular fares. A shuttle bus service provided by ICBC and BC Transit will then whisk you from the station to Northview Golf & Country Club free of charge. No need to compete for road space and parking spots with an estimated 10,000 golf fans on weekdays and 35,000 on weekends.

On weekdays the first SkyTrain from downtown arrives at Surrey Central Station at 6:28 am, on Saturdays at 7:28 am and on Sundays at 8:28 am.

Free shuttle schedules:

Monday	6:00 am - 9:00 am	Every 30 minutes
	9:00 am - 7:30 pm	Every 15 minutes
	7:30 pm - 10:30 pm	Every hour*
Tues-Thurs	6:00 am - 7:30 pm	Every 30 minutes
	7:30 pm - 10:30 pm	Every hour*
Friday	6:00 am - 9:00 am	Every 30 minutes
	9:00 am - 7:30 pm	Every 15 minutes
	7:30 pm - 10:30 pm	Every hour*
Saturday	6:00 am - 7:00 am	Every hour
	7:00 am - 7:30 pm	Every 15 minutes
	7:30 pm - 10:30 pm	Every hour*
Sunday	7:30 am - 8:00 pm	Every 15 minutes

* Operating from Northwood

Tell us your favourite golf story and win tickets to the GVO

Everyone who sends us a short story by August 13 will have his/her name placed in a hat. 17 names will be drawn to choose the winners of the following prizes: • **A pair of Clubhouse passes for the entire week** • **Six pairs of 7-day passes** • **10 pairs of 1-day passes.**

Mail, fax or e-mail your story (one per person please) along with your name, address and telephone number to GVO Contest, BC Transit Marketing, 13401-108th Ave, Surrey, B.C.V3T 5T4. Fax: 540-3455. e-mail: si_locke@bctransit.com

The better way to get to the PNE, August 16 - September 1

Transit

COMING EVENTS

The Bard on the Beach Shakespeare Festival presents *Love's Labour's Lost* and *The Winter's Tale* 'til Sept 21. Tx: 739-0559. Groups: 241-1228 ✓ Check out the GVRD Parks *Something's Up This Summer* program guide for details on nature programs and special events for the whole family. It's available in park kiosks or from the GVRD parks dept. 432-6359. Mon-Fri, 8 am - 4 pm ✓ The Vancouver TheatreSports League needs volunteers for light office work and archive retrieval. All volunteers get tickets to the shows. Call Denise McDonald at 738-7013 ✓ The Canadian Mental Health Assoc - North and West Vancouver Branch needs volunteer clerks able to work 3 to 4 hours weekly in their thrift store. 987-6959 ✓ Deep Cove Cultural Society presents Juno award winner *Long John Baldry*, Aug 13 to 16 at 8 pm. Deep Cove Shaw Theatre. Tx \$15. Rsv by Visa 929-9456 ✓ Free architectural walking tours of Vancouver, Tues-Sat, 1:30-3:30 pm. Info: Justine Murdy at 683-8588 ✓ VanDusen Gds, Oak & 37th, is offering a guided bird walk on August 23 at 6:30 pm ✓ Vancouver Art Gallery is now showing Baroque to Neo-Classical Sculpture in Quebec, an exquisite collection of sacred sculpture from the 17th, 18th and 19th Centuries ✓ See magnificent silver helmets, a 19th Century hand pumper, antique equipment and uniforms at *Firefighting through the Ages*, North Vancouver Museum & Archives, 209 West 4th St ✓ Vancouver Early Music Festival: *In Celebration of Schubert*, Aug 13, 8 pm, UBC Recital Hall. Pre-concert introduction at 7:15 pm. Info: 732-1610 ✓ *Different Views* features figurative works by seven BC artists. The diversity of the human form is shown through mixed media paintings and sculpture, Richmond Art Gallery, 7700 Minoru Gate ✓ Vancouver TheatreSports League presents *See BC: A Wild and Wicked Look at the People of B.C.*, Wed-Sat at 8:15 pm. Tx \$14/\$10 (Thursdays are two for one). Info: 738-7013 ✓ *Wooden Boat Festival* at Granville Island, Aug 21-24. Drop by and view these wooden beauties, many full of tall tales of life on the seas. Hands-on demonstrations.

Never open a can of worms unless you plan to go fishing

British Pensioners. The Canadian Alliance of British Pensioners will inform you of your pension rights at two meetings in New Westminster Library, Aug 16, 11 am and 1:30 pm. 6th Ave opposite Safeway.

FOR INFORMATION ON HOW TO GET THERE BY TRANSIT

TIMETABLES are available free of charge at public libraries, city and municipal halls, community centres, and the BC Transit Lost Property Office at Stadium Station. **TRANSIT ROUTE MAP AND GUIDES** offer a map, a listing of all routes, and fare information. They're available at Safeways, 7-Elevens, SkyTrain station convenience shops and most FareDealers for a small charge. **THE YELLOW PAGES** show a route map, a list of bus routes and fare information. **INFORMATION BY TELEPHONE:** 521-0400. West Vancouver 985-7777, or call Talking Yellow Pages: 299-9000, #2233.

Aug 23/24 - Burnaby Potters' Guild Annual Show & Sale, Burnaby Arts Centre, 6450 Deer Lake Park, 10 am-4 pm

Printed on Recycled Paper
Vol 82 No 16 ISSN 0714-1688

Acc # 2004-1-203 1/2
BUZZER
PUBLISHED BY BC TRANSIT, FRIDAY, AUGUST 8, 1997

Win tickets for the Indy Win tickets for the GVO

Beginning September 1
New & revised trolley routes
with buses scheduled to come more often

Free shuttle service to the GVO

The better way to get to PNE Fun

From Downtown
On Granville Mall, board a 4 Powell, 14 Hastings or 16 29th Avenue Station bus for direct service to the PNE

From West Vancouver
Take a Blue Bus to downtown Vancouver and transfer to a northbound #4, #14 or #16 on Granville Mall for direct service to the PNE.

From North Vancouver
#28 and #210 buses provide regular service to the PNE from Phibbs Exchange. The #28 stops on Cassiar at Hastings. The #210 stops on McGill at Renfrew.

From Coquitlam
#151 and #152 buses provide direct service to the PNE from Coquitlam Centre and Lougheed Mall. Both routes stop at Hastings & Renfrew and Hastings & Cassiar.

From Port Moody/Coquitlam Centre/Port Coquitlam
#160 buses connect Port Moody, Coquitlam Centre and Port Coquitlam with the PNE. The buses stop at Hastings & Renfrew and Hastings & Cassiar.

From Richmond
Take a Vancouver-bound bus to Broadway & Granville and transfer to a Special Broadway-PNE bus.

From North Burnaby
Board a 123 Stanley Park or 135 Stanley Park bus for direct service to Hastings & Cassiar, Windermere or Renfrew. Or take a local bus to Kootenay Loop and transfer to a 10 UBC.

From South Burnaby/New Westminster
Take a local bus to any SkyTrain station. Ride SkyTrain to 29th Avenue Station and transfer to a special PNE Express (Bay #1). Or board a #123 on Canada Way or Willingdon.

From Surrey/North Delta
Take a local bus to any SkyTrain station. Ride SkyTrain to 29th Avenue Station and transfer to a special PNE Express (Bay #1).

Three express routes to the PNE

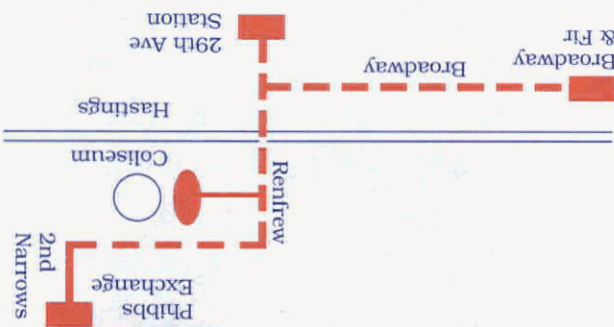

From South Delta/Ladner
Take a #640 to Scott Road Station (wheelchair passengers transfer to Surrey Central Station). Ride SkyTrain to 29th Avenue Station and transfer to a special PNE Express bus (Bay #1). Or take a #601 bus to Broadway & Granville and transfer to a special Broadway-PNE bus.

From White Rock/South Surrey
Take a #321 or 390 bus to Surrey Central Station, ride SkyTrain to 29th Avenue Station and transfer to a special PNE Express bus (Bay #1). Or take a #351 bus to Broadway & Granville and transfer to a special Broadway-PNE bus.

New attractions at the PNE
The 1997 Coca Cola Celebration Parade, an on-site entertainment extravaganza twice daily, 5 pm and 9 pm. **Agrodomo Live**, a twice daily entertainment show featuring the RCMP Musical Ride, the Skool Pro Rodeo Finals, and the PNE Grand Prix Horse Jumping Event. For thrill seekers, **The Evolution** is the latest in amusement ride technology. The first five correct answers drawn were submitted by: Irene Cawson, Anita Just, Ron Quick, Cheryl Stittle and Justin Wong. Each of them will receive 2 PNE adult admission passes, 2 ride passports, 2 PNE "Unbelievably Fun" T-shirts and 2 BC Transit DayPasses.

PNE Prize Package winners
The first five correct answers drawn were submitted by: Irene Cawson, Anita Just, Ron Quick, Cheryl Stittle and Justin Wong. Each of them will receive 2 PNE adult admission passes, 2 ride passports, 2 PNE "Unbelievably Fun" T-shirts and 2 BC Transit DayPasses.

\$5 off with a FareCard

Get \$5 off any General admission ticket to the Molson Indy Vancouver, August 29, 30 and 31 by presenting this coupon and your valid FareCard at any TicketMaster outlet or on-site ticket booth on race weekend. Two tickets per card shown. For race information call 280-INDY. For information on your best transit route to the Indy, check the August 22 issue of The Buzzer or call 521-0400.

Name the 1994, 95 and 96 winners of the Vancouver Indy and explain in 15 words or less why you will be taking transit to the race. Send in your entry (one per person please) with your name, address and telephone number to:
The Buzzer/Indy Contest: BC Transit Marketing, 13401 108 Ave, Surrey, B.C. V3T 5T4
or fax 540-3455, or e-mail: si_locke@bctransit.com
Entries will be judged on August 18 and prizes awarded as follows:
1st. Two 3-day Gold tickets 2nd. Two 3-day Red tickets 3rd. Two 3-day Blue tickets 4th. Two 3-day Gen. Adm.
Winners will be contacted by telephone and their names will be published in the August 22 issue of The Buzzer.

Win one of four pairs of tickets for the Indy, Aug 29, 30 & 31

New and revised trolley bus routes begin September 1

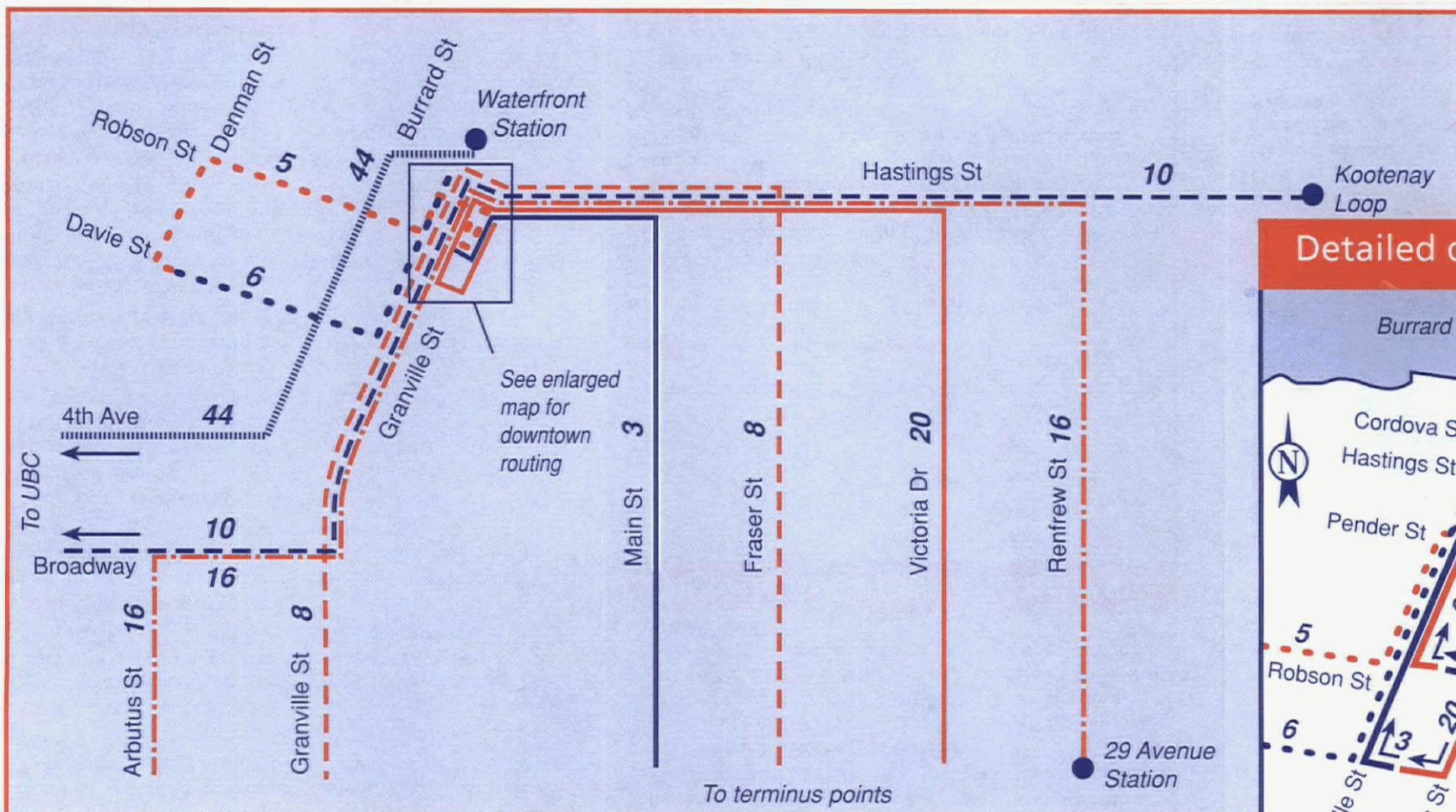

Detailed downtown routing

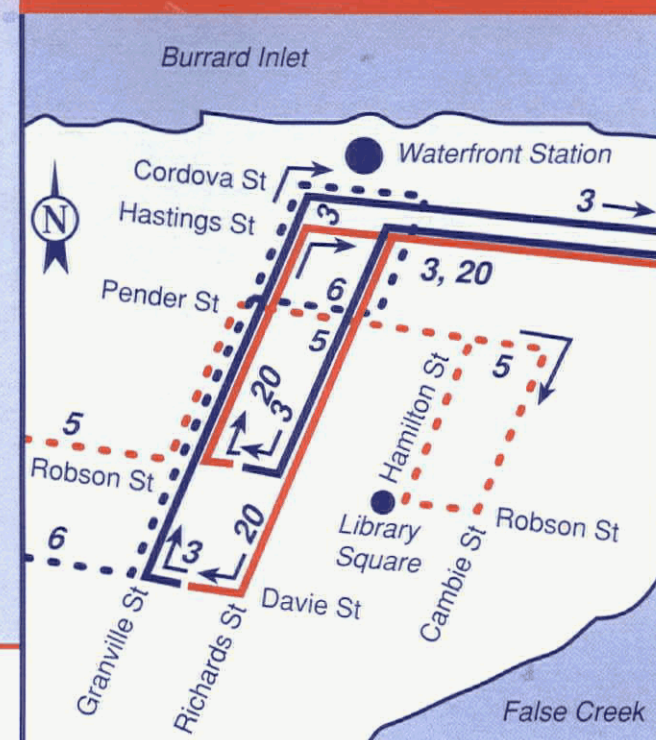

Downtown stops: buses travelling in both directions will pick-up and drop-off passengers at all downtown bus stops.

Limited stops: buses travelling in both directions will stop to pick-up and drop-off passengers at Burrard & 3rd Ave and on 4th Ave at Vine, Macdonald, Alma and Sasamat.

Revised stopping procedures on the #151, 152 and 160 routes improve express services

151 and 152 Vancouver westbound buses now pick up and drop off passengers at Brentwood Exchange (Bay 1). 151 and 152 Coquitlam Station/Port Coquitlam Centre eastbound buses now pick up and drop off passengers on Lougheed Hwy at Willingdon. 160 Vancouver/Coquitlam Station/Port Coquitlam Station buses travelling in both directions now pick up and drop off passengers at Inlet and Ridge.

#321/390 route adjustments

Buses leaving the Pacific Inn Hotel terminus no longer operate southbound on 164 Street, westbound on 10 Avenue and northbound on Stayte (160 St). They are now routed via King George Highway, 16 Avenue to 152 Street (White Rock Centre) then the regular route.

Commuter Cycling Map

Second edition now available
The map features recommended cycling routes, bicycle locker locations, parks, park & rides, traffic volumes, bridge crossings and major hills. Copies are available for sale at the Alternative Transportation Centre's Main Station Bikes Store, 195 Main St. Info: 669-BIKE

BC Lions ticket winners

The first five correct entries drawn were submitted by Lorraine Campbell of Coquitlam, Margaret Haller of New Westminster, Earl Henswold and Diane McKellar of Surrey and Leanne Kett of Burnaby. Each has won pairs of tickets to the Montreal and Calgary games, August 9 and 22. Congratulations to the winners and our thanks to all who entered.

When you're in deep water it's a good idea to keep your mouth shut

Beginning September 1, you aren't going to have to think as much about how you'll get to your downtown destination and make connections to other points in the city. We've simplified things by providing extra service and new, revised and renamed bus routes with new connections. The result should be a greater opportunity to get to your destination sooner. Now you can concentrate on thinking about the more important things in life.

Revised route - 3 Main/Downtown

The existing #3 will be divided into two routes: the downtown portion will operate as a separate new trolley service (#5 Robson) and the portion on Main Street will operate as a #3 Main/Downtown.

#3 westbound: buses will follow the existing route from Marine & Main to Hastings & Richards and will then travel via Richards to Robson & Richards.

#3 eastbound: from the terminus at Davie & Richards, buses travel from Davie, Granville, Cordova and the existing route to Marine & Main.

New route - 5 Robson/Downtown

This new route replaces the downtown portion of the #3 Main/Robson and will operate in the West End and Downtown area only with more frequent service. It extends to Library Square.

Eastbound route: From Davie & Denman via Davie, Denman, Robson, Granville, Pender, Cambie and Hamilton to the terminus between Cambie & Hamilton.

Westbound route: From Robson between Cambie & Hamilton via Robson, Hamilton, Pender, Granville, Robson, Denman and Davie to Davie at Denman.

New route - 6 Davie/Downtown

This route will replace the downtown portion of the #8 Fraser. It will operate within the West End and Downtown area only with more frequent service. It extends to Waterfront Station.

Eastbound route: from Davie at Denman via Davie, Granville, Cordova and Richards to the terminus between Cordova and Hastings.

Westbound route: from Richards between Cordova and Hastings via Pender, Granville and Davie to Davie at Denman.

Revised route - 8 Fraser/Granville

The #8 will now operate along Granville and Fraser Streets. The downtown portion of the route will become a separate new trolley service (#6 Davie).

Westbound route: From the terminus at Marine & Fraser via the existing route to Granville & Davie, then via Granville to Marpole Loop.

Eastbound route: From the terminus at Marpole Loop via Granville, Cordova and the existing route to Marine & Fraser.

Revised route - 10 Hastings/UBC

The #10 route between downtown Vancouver and UBC will be extended to operate between Kootenay Loop and UBC. Monday to Saturday mid-day service will increase to every 12 minutes, from every 15.

Westbound route: from Kootenay Loop via Hastings, Granville and the regular route to UBC.

Eastbound route: From UBC Loop via the existing routing to Granville & Pender, then via Granville and Hastings to Kootenay Loop.

Revised route - 16 29th Ave Station/Arbutus

The #16 route which terminated in downtown Vancouver will be extended to serve Arbutus.

Westbound route: from 29th Avenue Station via existing route to Hastings & Richards, then via Hastings, Granville and existing Arbutus route to 63rd Loop.

Eastbound route: from 63rd Loop via existing Arbutus and #16 routes to 29th Avenue Station.

Revised route - 20 Victoria/Downtown

The #20 route will operate between Victoria Drive and downtown Vancouver with increased service frequencies during mid-day and the PM peak period.

Westbound route: from Harrison Loop via the existing route to Hastings & Richards, then via Richards to terminus at Davie & Richards.

Eastbound route: From Robson & Richards via Robson, Granville and Hastings, then via existing route to Harrison Loop.

New route - 44 Downtown/UBC

The #44 is a new limited-stop service operating between Waterfront Station and UBC via Kitsilano. During the AM peak, buses will leave Waterfront Station every 15 minutes, providing UBC travellers with more opportunities to get to campus on time. After 8:45 am (until 9:50 am) the service frequency will be every 30 minutes; during the PM peak, from 2:35 to 5:35, it will be every 30 minutes from UBC to Waterfront Station.

Westbound route: from Waterfront Station via Cordova, Granville, Hastings, Burrard, 4th Avenue, Blanca, University Blvd to UBC Loop.

Eastbound route: from UBC Loop (Bay #7) via University Blvd, Blanca, 4th Avenue, Burrard, Hastings, Granville and Cordova to Waterfront Station.